

TEMAAL



temalette

TKKA-korkea kaappi

TKKA-högsåp

Asennusohje versio 1/2011
Monteringsanvisning version 1/2011

Osaluettelo

| Nimike | Määrä kpl |
|---|-----------|
| Asennusohje | 1 |
| Suora ovi | 1 |
| Komeron sivu | 2 |
| Komeron ala- ja yläpohja | 2 |
| Komeron hylly | 4 |
| Komeron taustalevy | 1 |
| Sidelista | 3 |
| Tukilista | 1 |
| Välisoiro 636 x 100 x 16 mm (TKKA-kaapin ja allaskaapin väliin) | 1 |
| | |
| Hyllynkannatin 5 mm, valkoinen | 16 |
| Minihela 15 | 14 |
| Minihelapultti 15 | 14 |
| Liimatuubi 15 g | 1 |
| | |
| Sarana | 3 |
| Saranan aluslevy | 3 |
| Saranan vaimennin | 1 |
| Ruuvi uppokanta saranoihin 3,5 x 13 mm | 6 |
| | |
| Nuppivedin | 1 |
| Tankovedin | 1 |
| Vedinruuvi matala 4 x 20 mm | 2 |

Delförteckning

| Artikel | Antal st. |
|--|-----------|
| Monteringsanvisning | 1 |
| Slät lucka | 1 |
| Skåpets sida | 2 |
| Skåpets undre och övre plan | 2 |
| Hylla | 4 |
| Skåpets bakstycke | 1 |
| Förbindningslist | 3 |
| Stödlist för väggmontering | 1 |
| Passbit 636 x 100 x 16 mm (mellan TKKA-skåpet och underskåpet) | 1 |
| | |
| Hyllbärare 5 mm, vit | 16 |
| Kopplingsbeslag 15 | 14 |
| Kopplingskrav 15 | 14 |
| Limtub 15 g | 1 |
| | |
| Gångjärn | 3 |
| Gångjärnets motstycke | 3 |
| Gångjärnsdämpare | 1 |
| Gångjärnsskrav 3,5 x 13 mm | 6 |
| | |
| Knopphandtag | 1 |
| Stånghandtag | 1 |
| Handtagsskrav 4 x 20 mm | 2 |

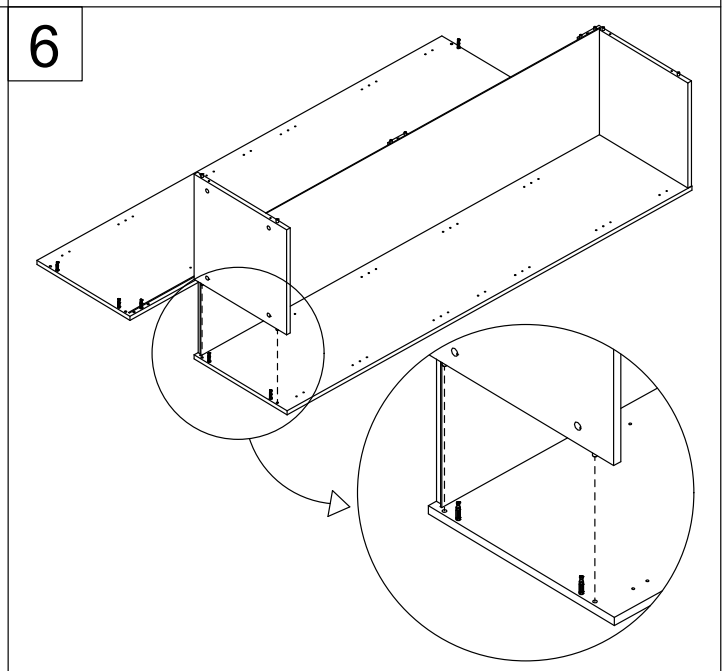
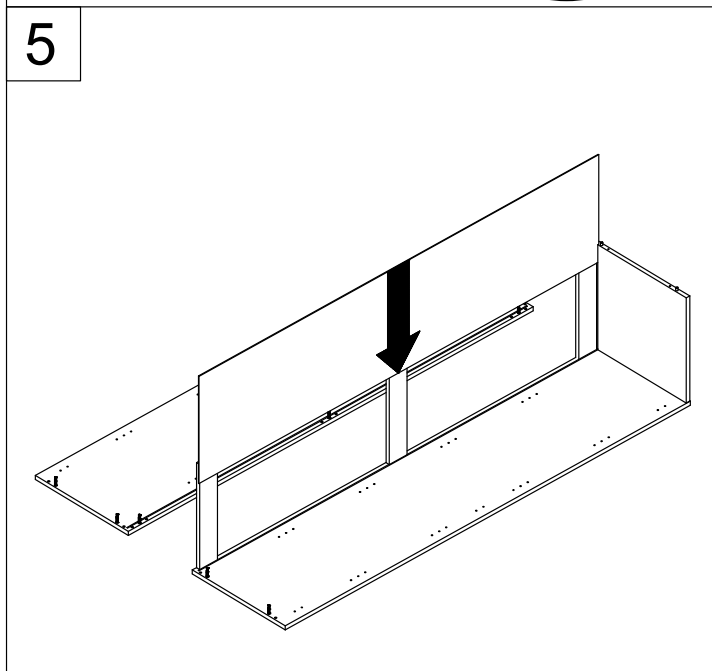
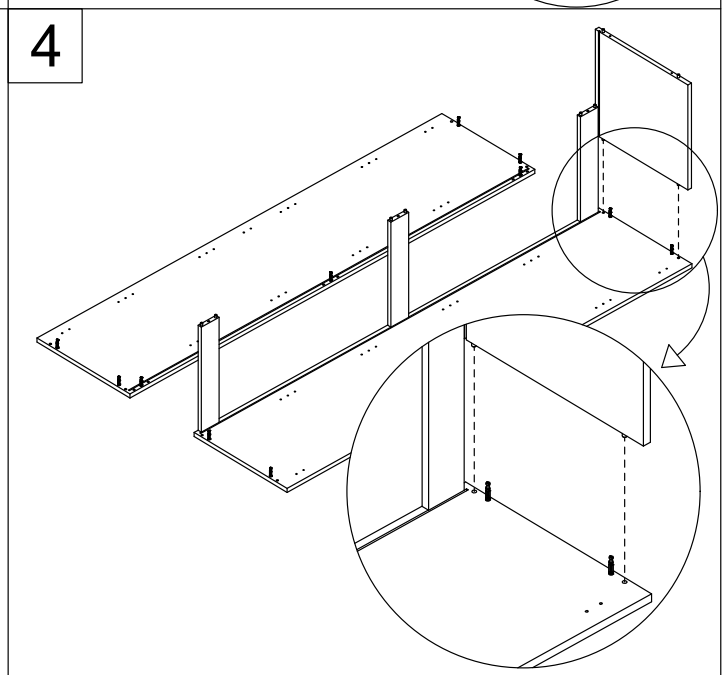
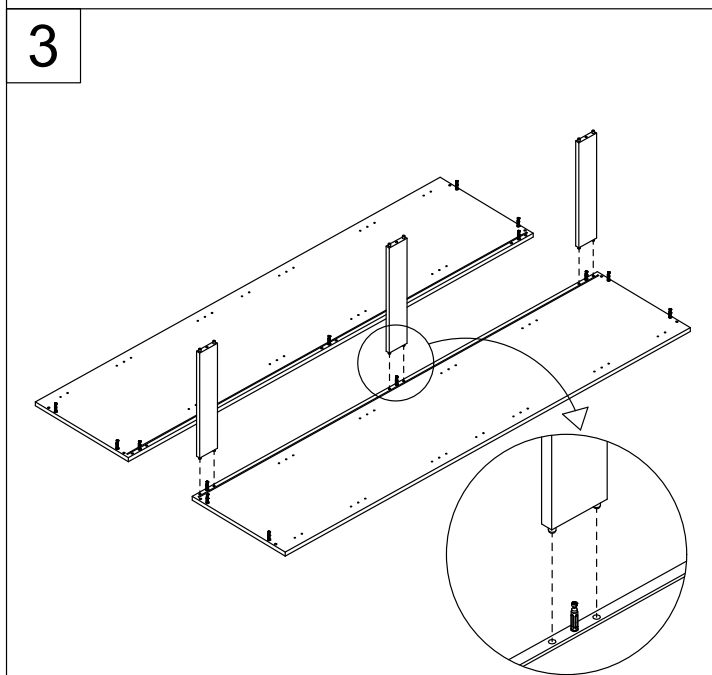
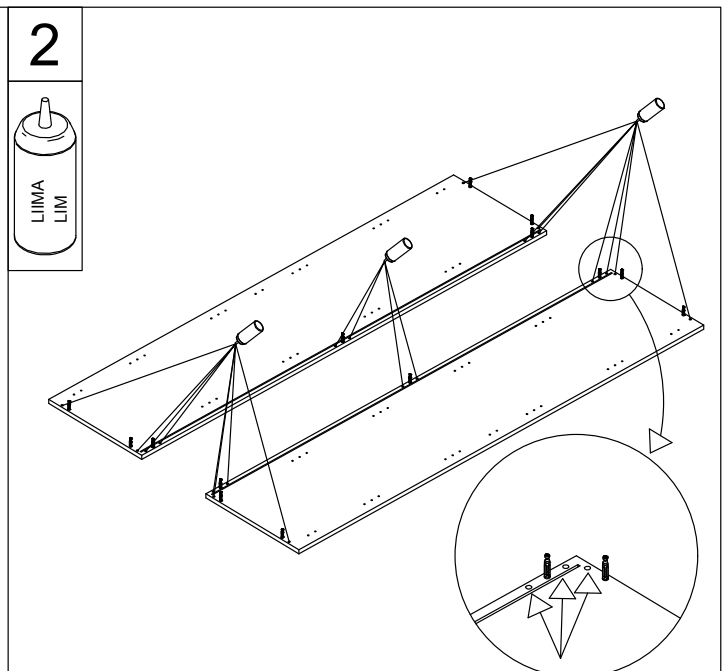
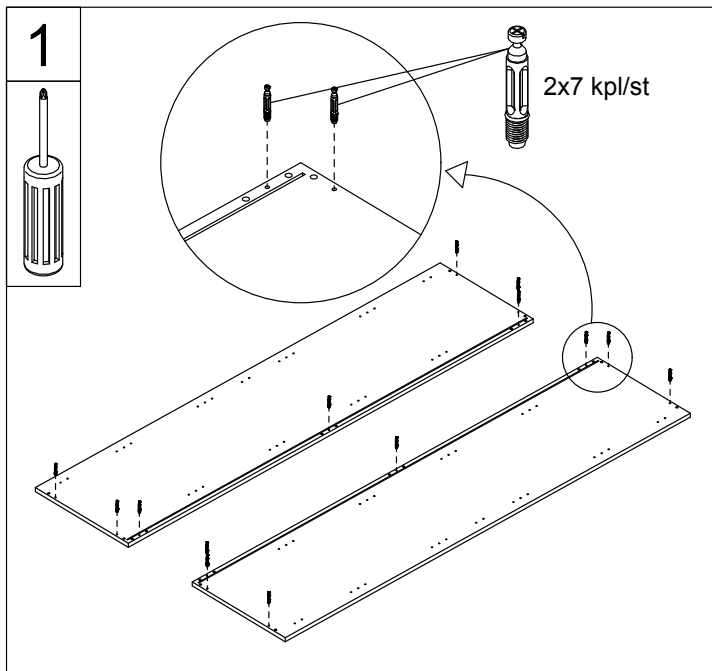

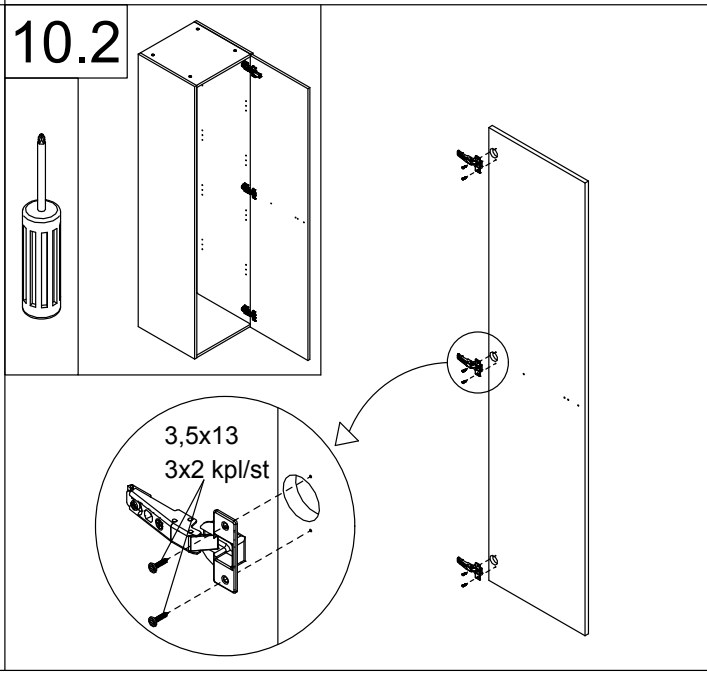
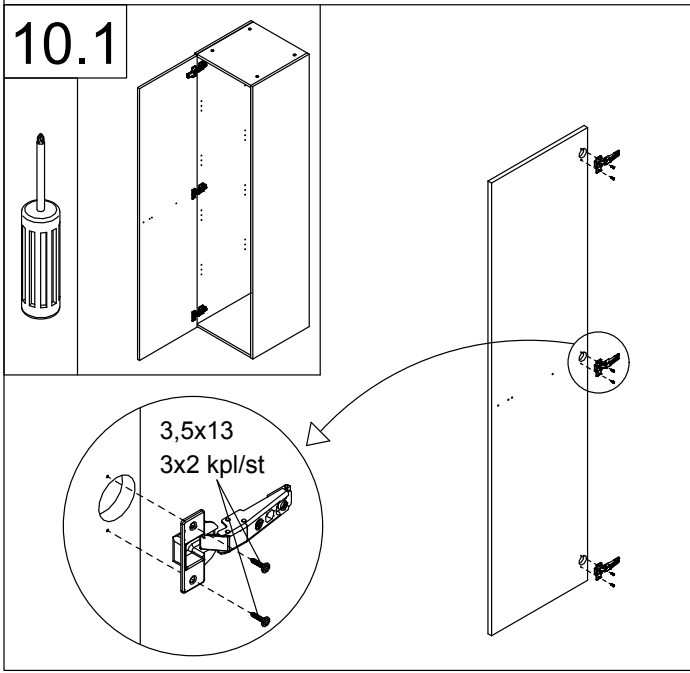
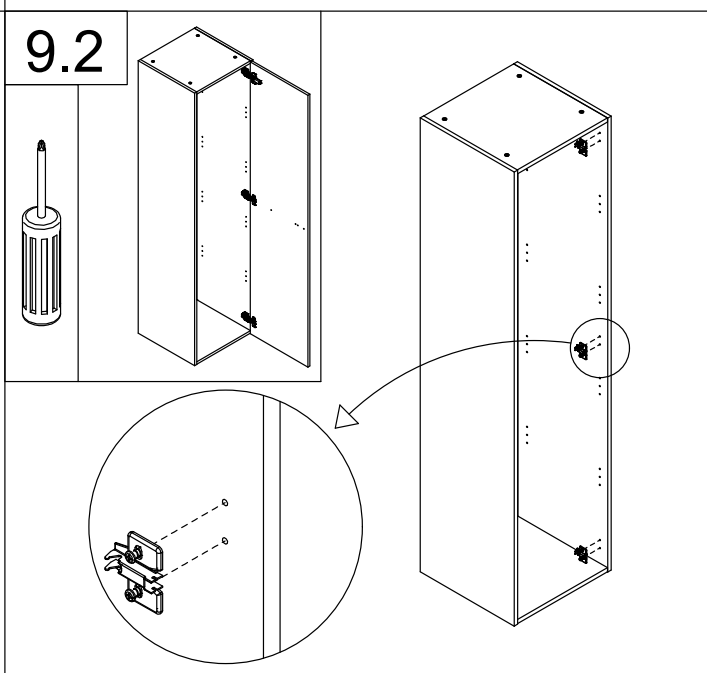
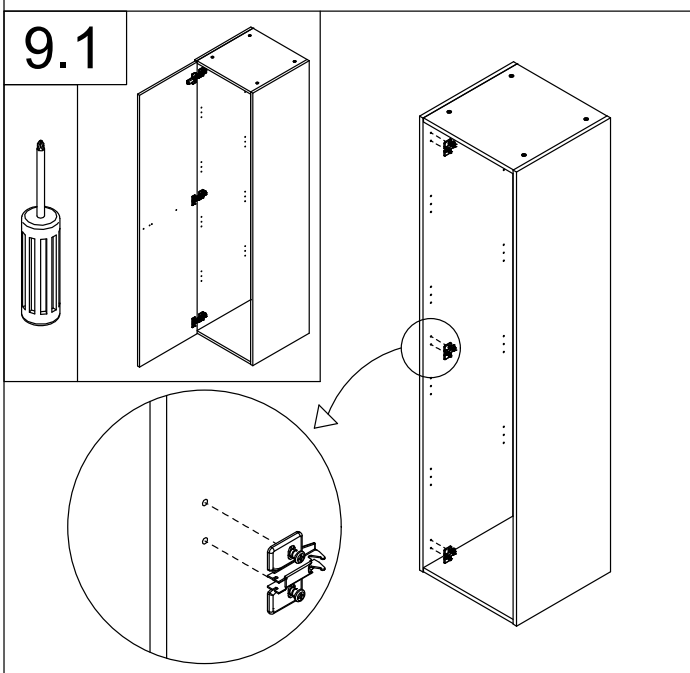
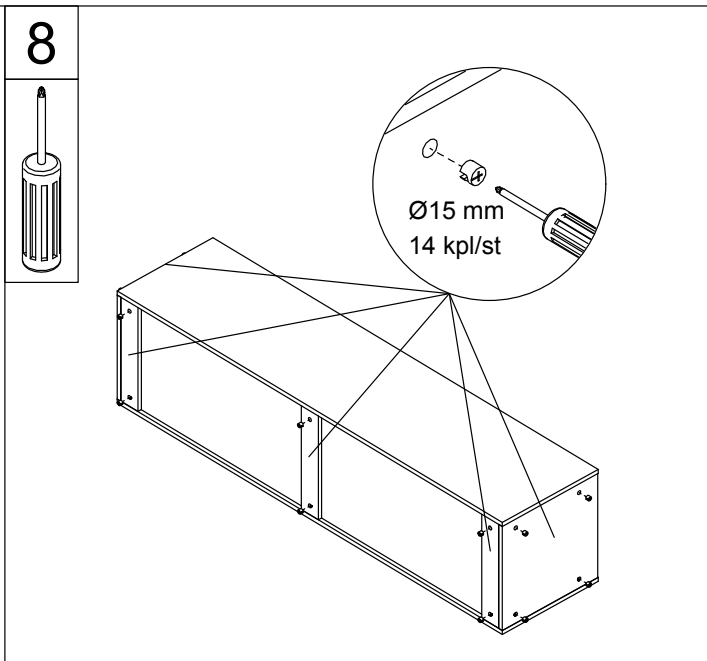
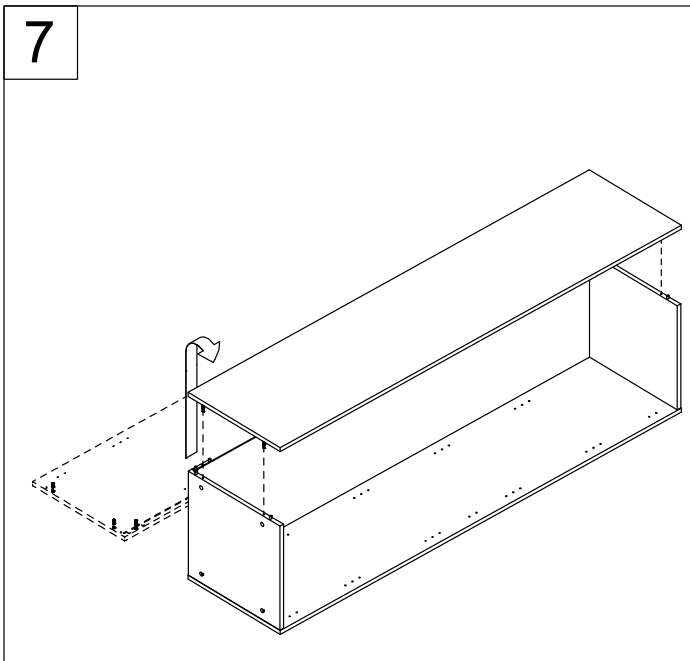

11.1

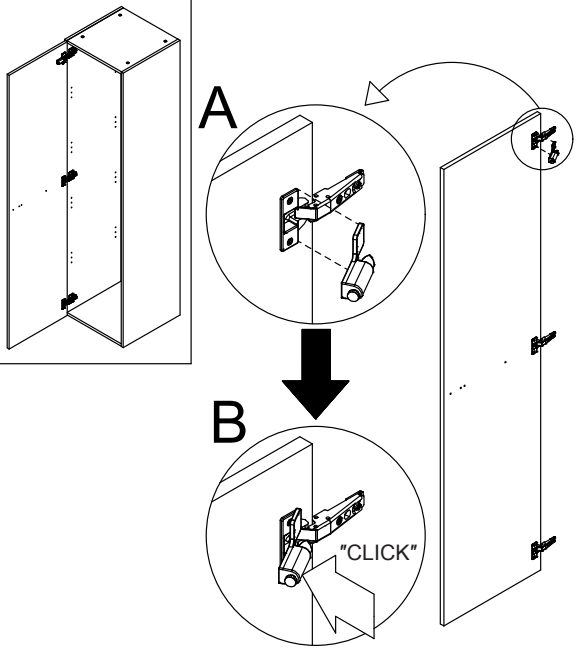

11.2

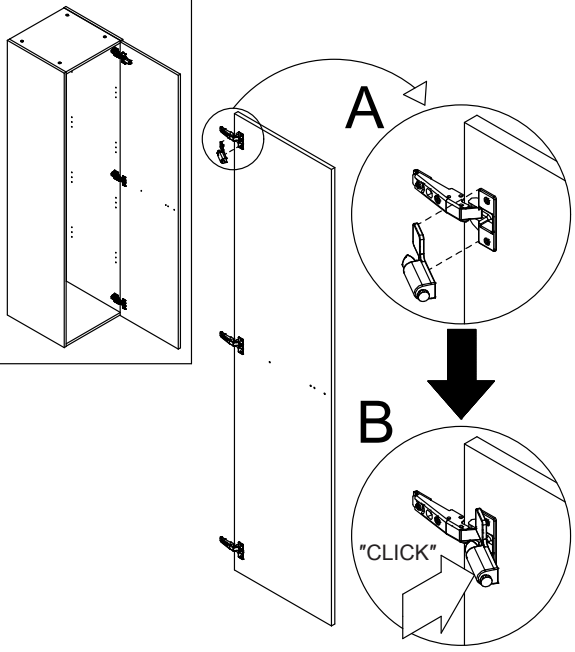

12

A

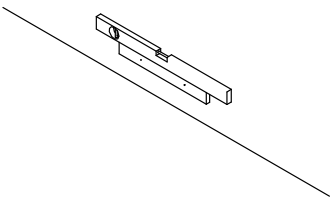

B

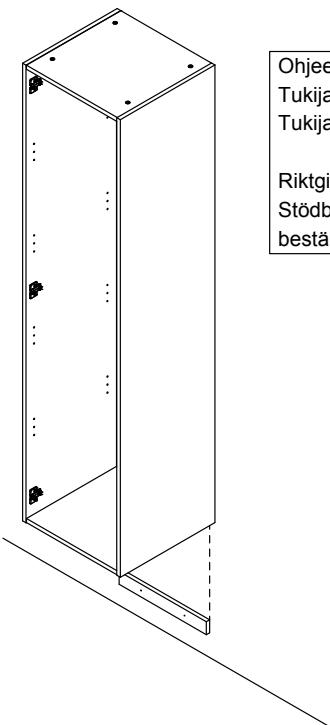

Ohjeelliset asennuskorkeudet
 Tukijalan korkeus: 90/150/200 mm
 Tukijalka tilattava erikseen

Riktgivande monteringshöjder för stommen
 Stödbenshöjder: 90/150/200 mm,
 beställs separat

1910/1970/2020

1852/1912/1962

90/150/200

148/208/258

65/125/175

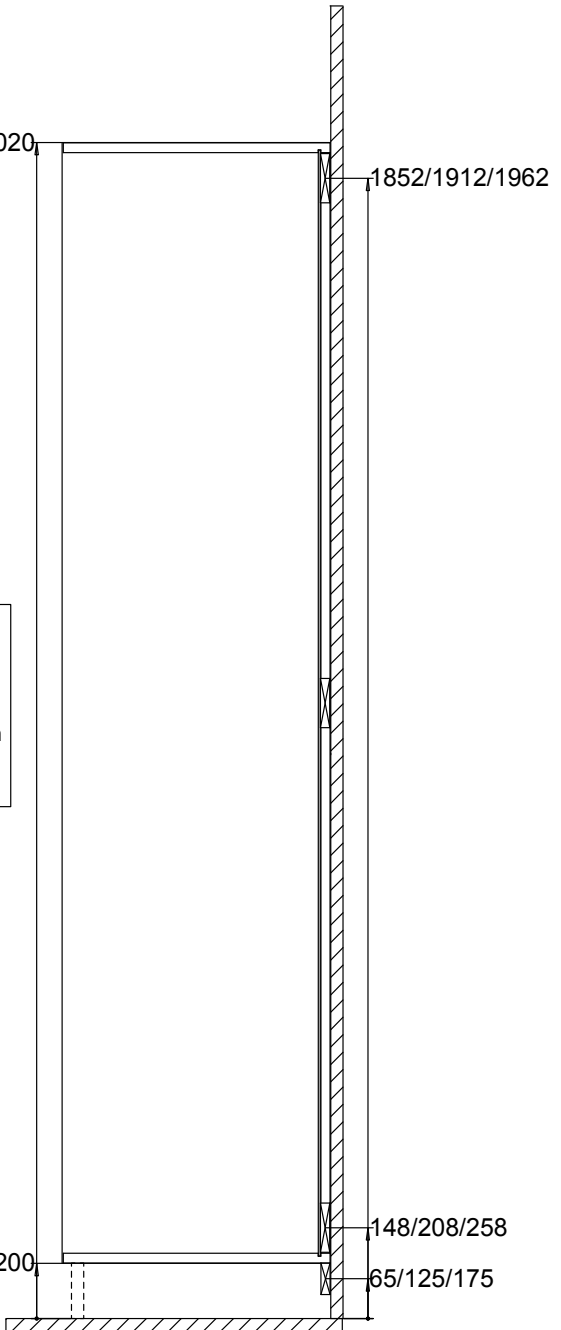

13

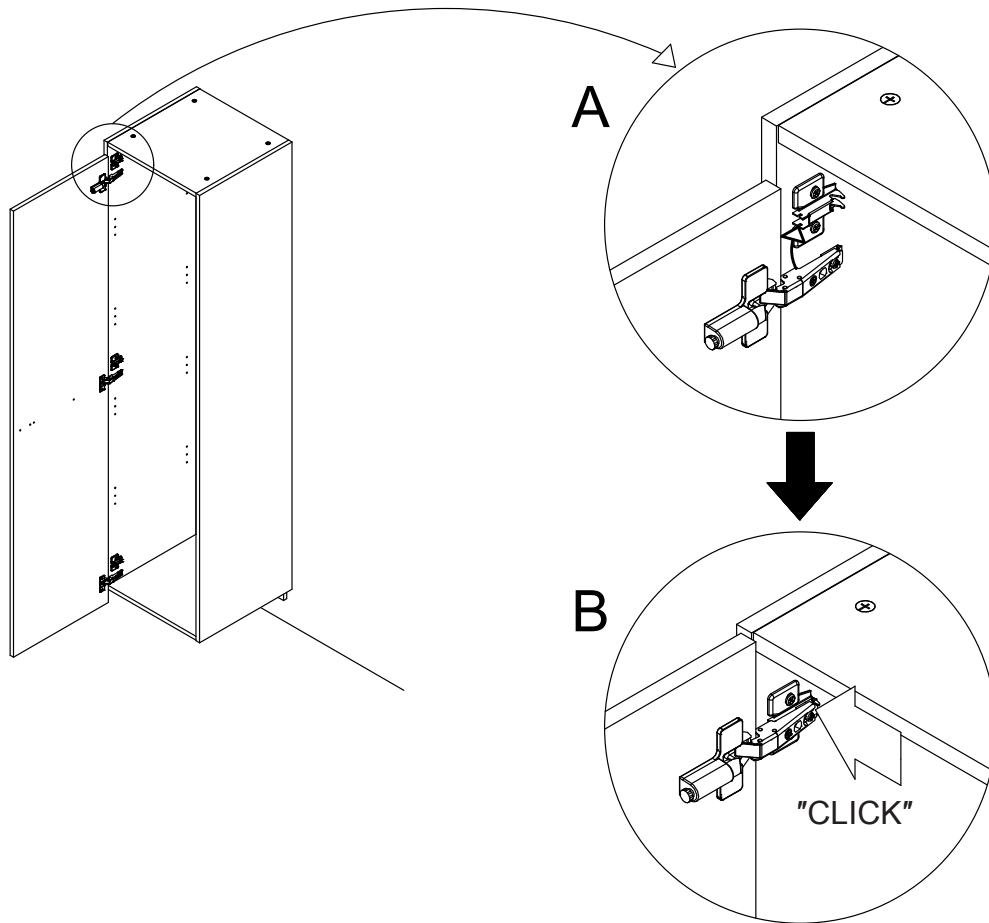

14.1

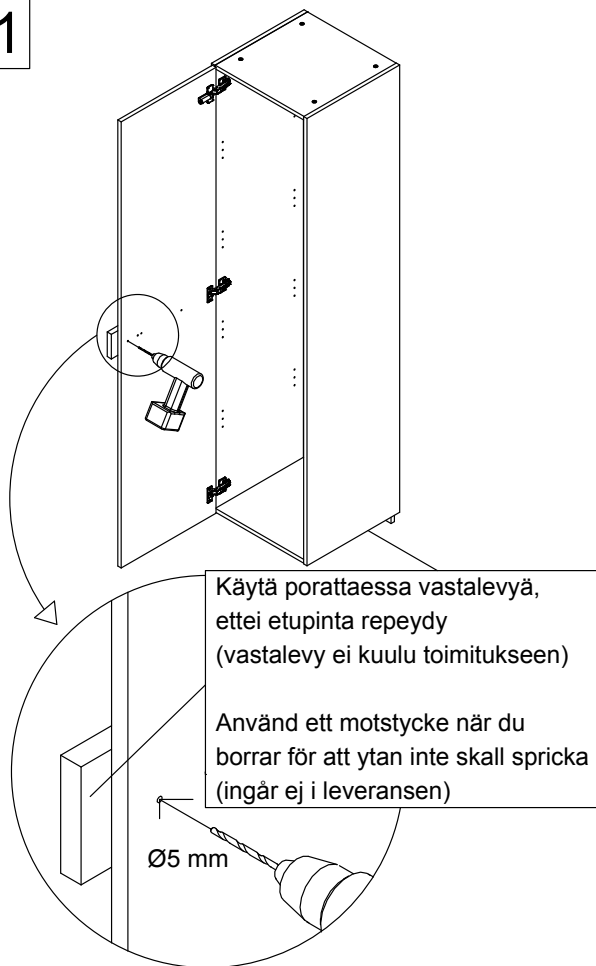

14.2

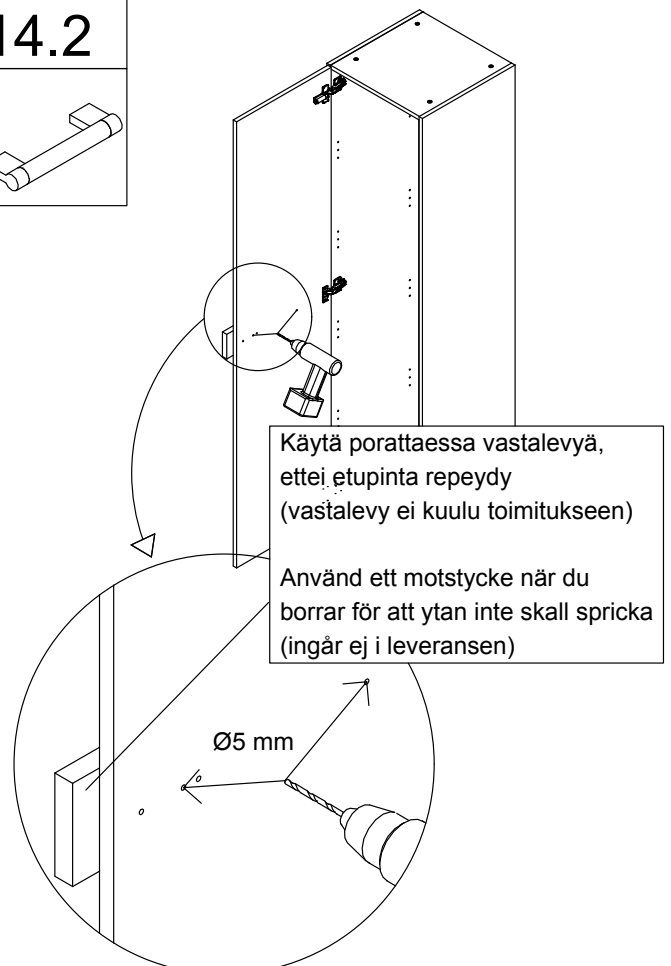
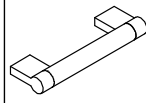

15.1

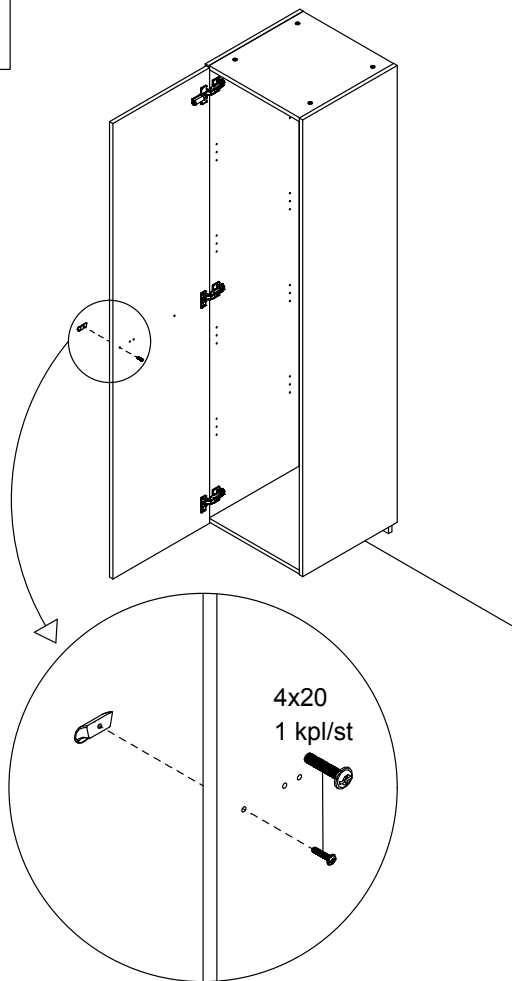
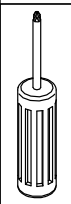

15.2

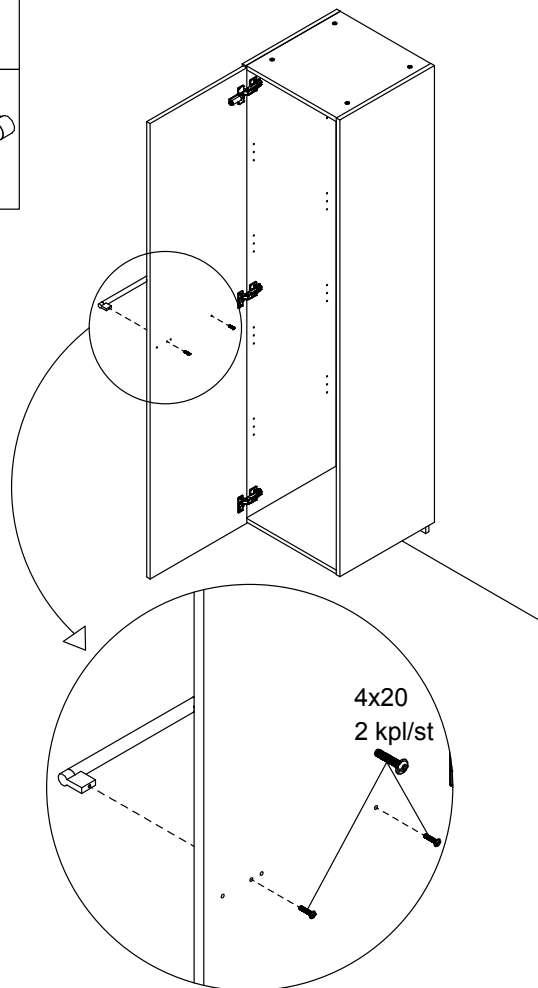
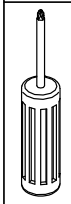
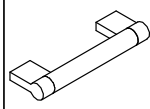

16

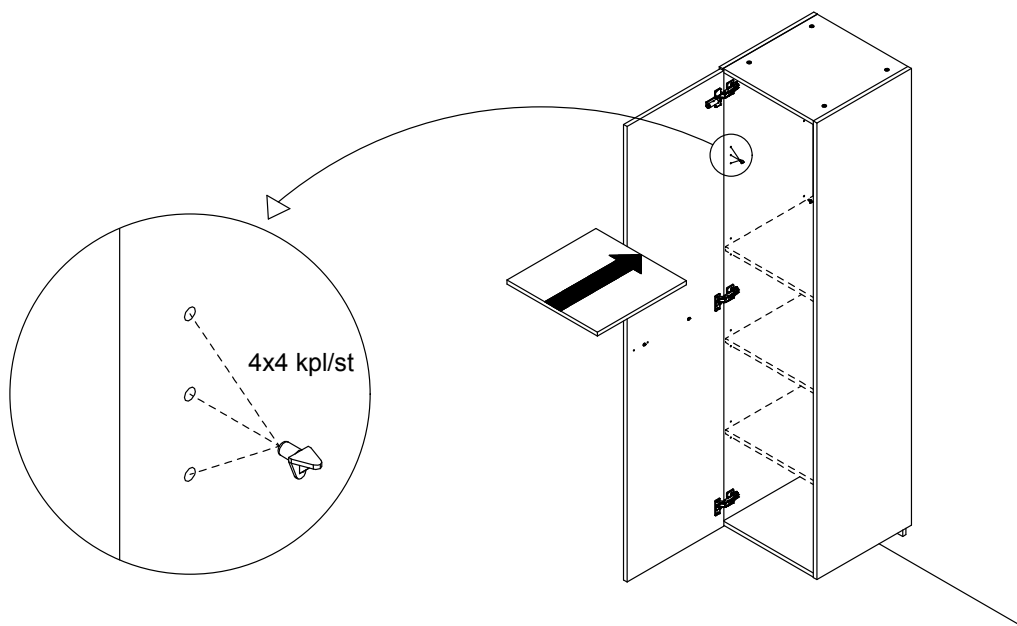

17

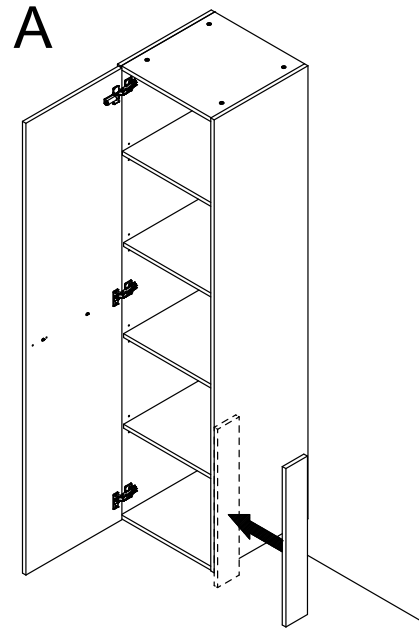
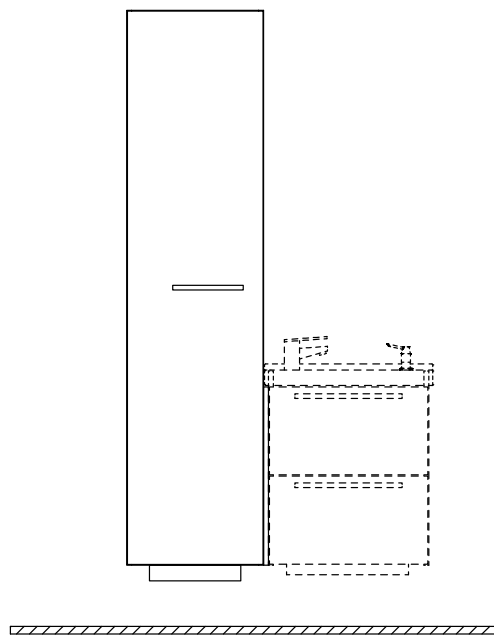

B

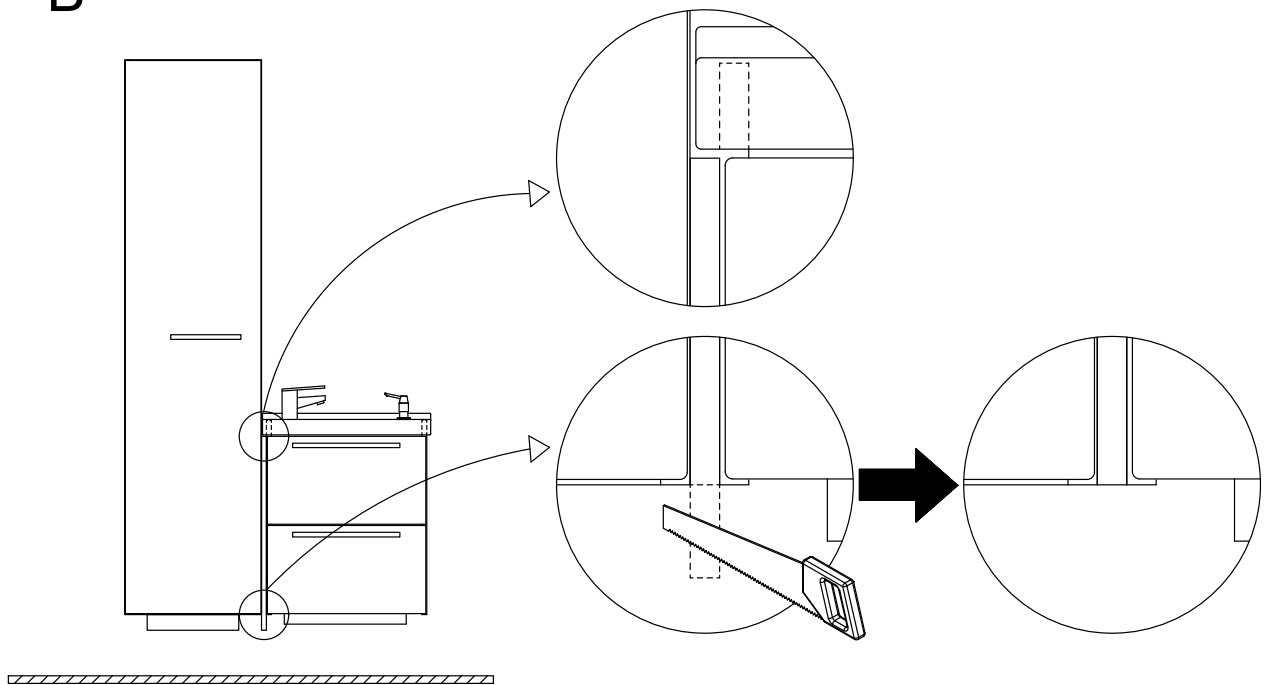

SARANOIDEN ASENNUS JA SÄÄTÖ MONTERING OCH JUSTERING AV GÅNGJÄRN INSTALLATION AND ADJUSTMENT OF HINGES

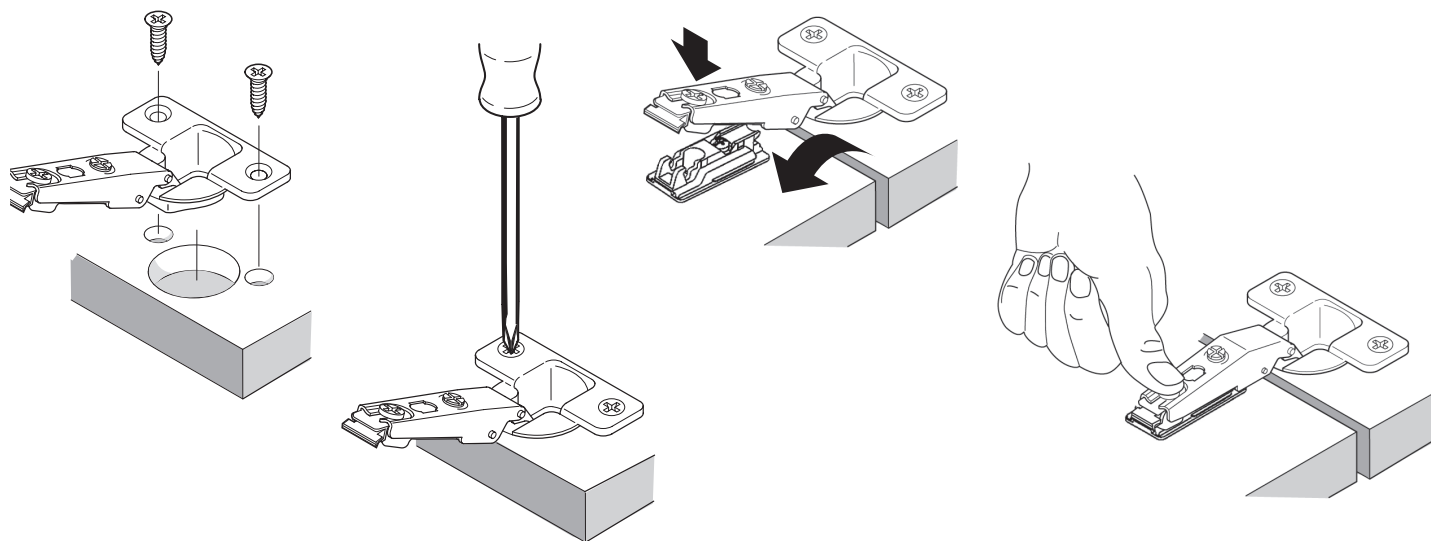

IRROITUS/LOSSNING/DETACHMENT

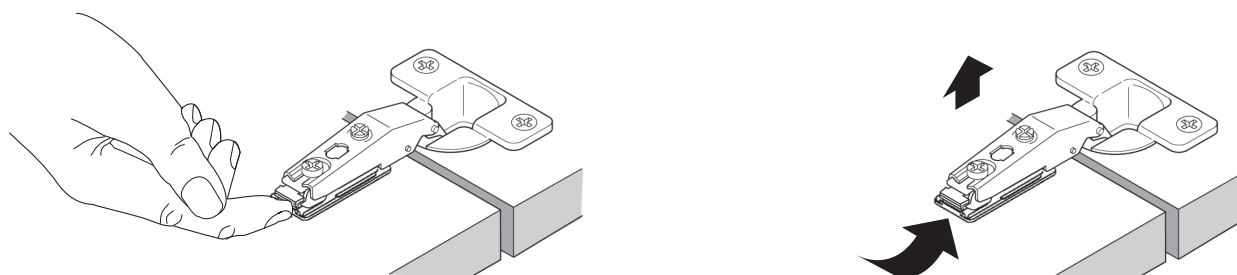

OVIEŃ SÄÄTÖ/JUSTERING AV LUCKOR/ADJUSTMENT OF DOOR

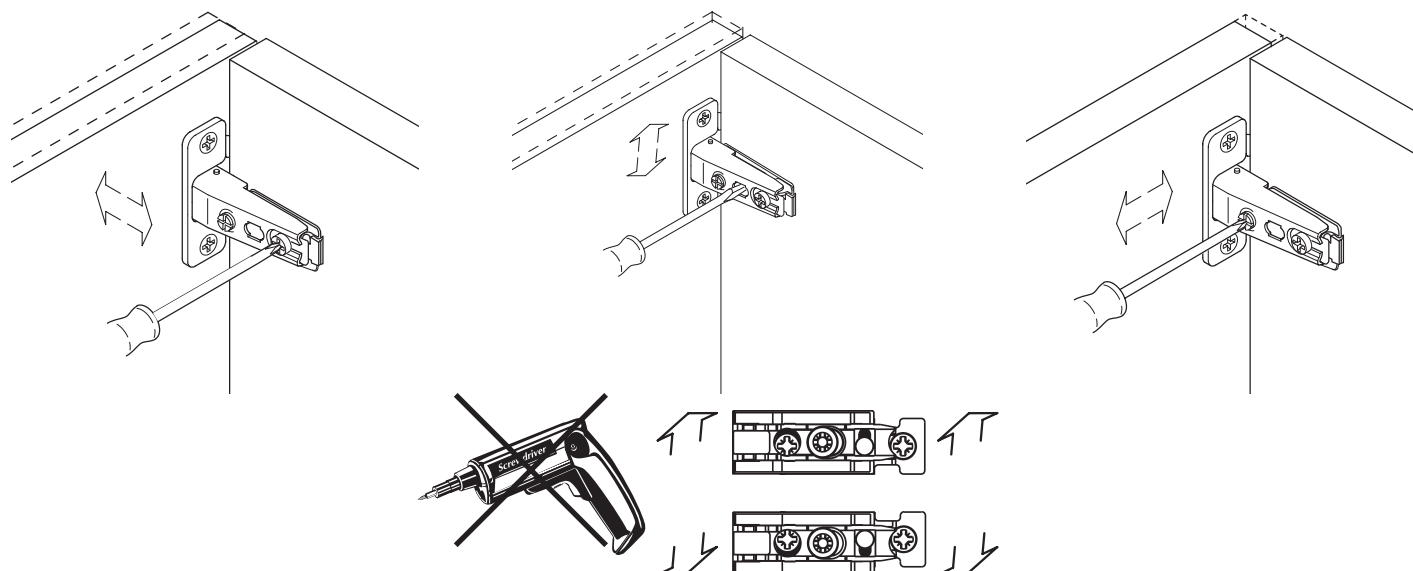

Soft-close CS

MEPLA  ALFIT
Feel the motion!

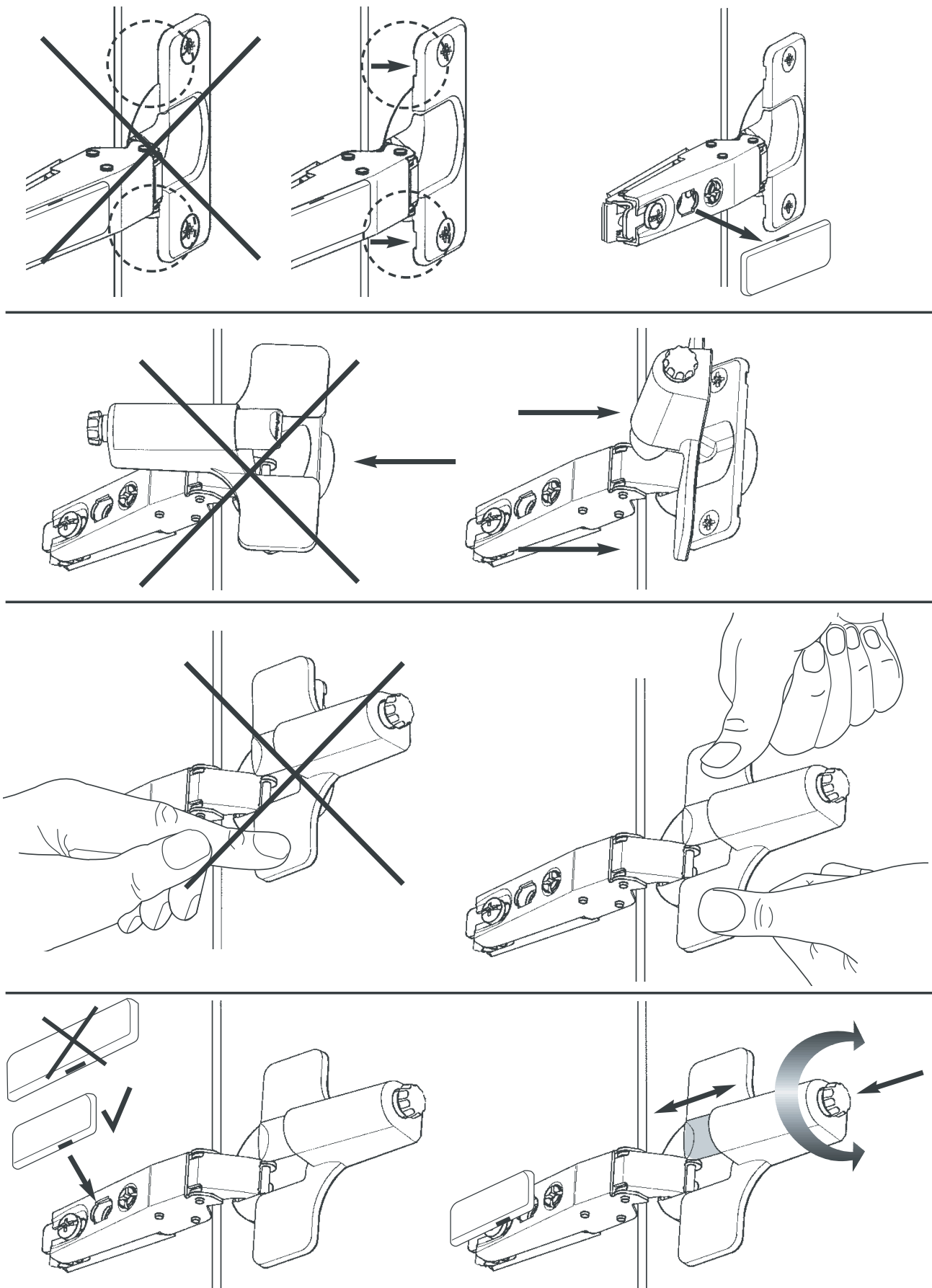



Temal Oy
Tehtaankatu 2
04400 Järvenpää
Puh. 010 217 2300
Fax 010 217 2301
www.temal.fi



Temal Oy
PB 74, Tehtaankatu 2
FI-04401 Järvenpää
Tel. +358 10 217 2313
fax +358 10 217 2303
www.temal.se